



**PRESSURE SWITCHES  
PRESSURE DIFFERENCE SWITCHES  
VACUUM SWITCHES**  
From 1.5 mbar to 600 bar

## MT High Range DP

# CATALOGUE

Certificate No.: FM72815



### **Kaustubha Udyog**

S. No. 36/1/1, Sinhgad Road, Vadgaon Khurd,  
Near Lokmat Press, Pune 411 041 INDIA  
Tel. : +91-(0) 20-24393577 / 24393877  
Telefax : +91-(0) 20-24393577 / 25460486  
Email : ku.pressure@gmail.com

**Website : <http://www.orion-instruments.io>**

# MD/MT HIGH RANGE DP



## MD



### PRESSURE CAPSULE DETAILS

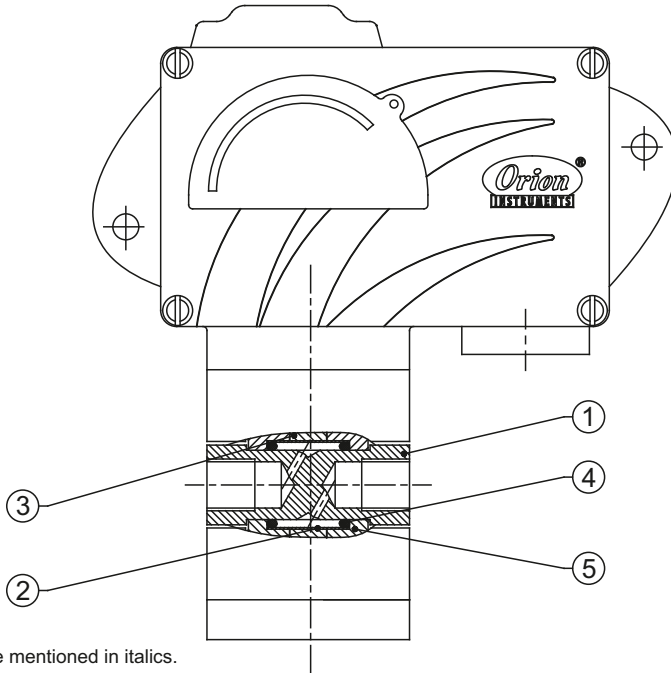

#### No. Description

1. Pressure Housing (SS)
2. Diaphragm (SS or PTFE<sup>®</sup>)
3. Plunger (SS)
4. O-Ring (Viton)
5. Disc (Al)

Note : *wetted parts* are mentioned in italics.

### INSTALLATION DRAWING

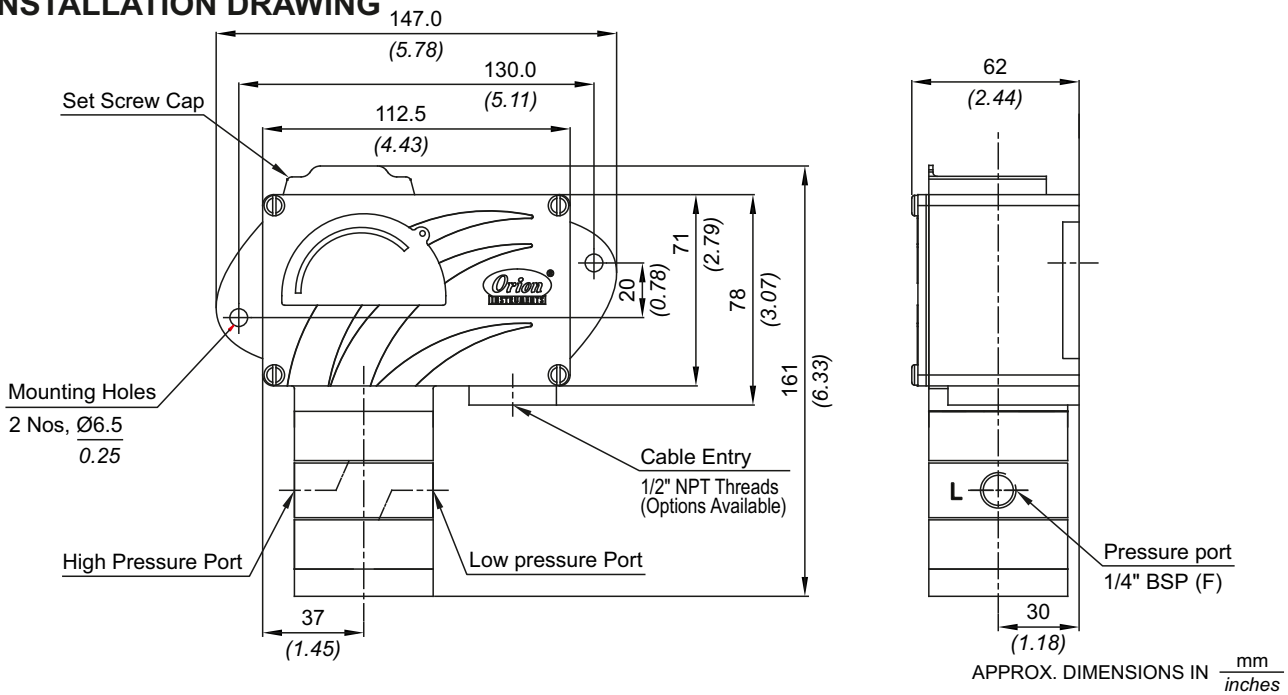



## MT



### PRESSURE CAPSULE DETAILS

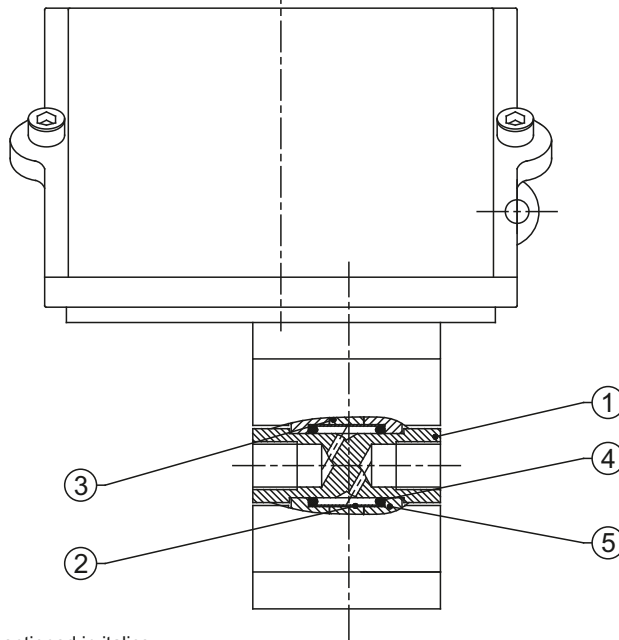

#### No. Description

1. Pressure Housing (SS)
2. Diaphragm (PTFE®)
3. Plunger (SS)
4. O-Ring (Viton)
5. Disc (Al)

Note : *wetted parts* are mentioned in italics.

\*Pressure ports are brazed with flange

### INSTALLATION DRAWING

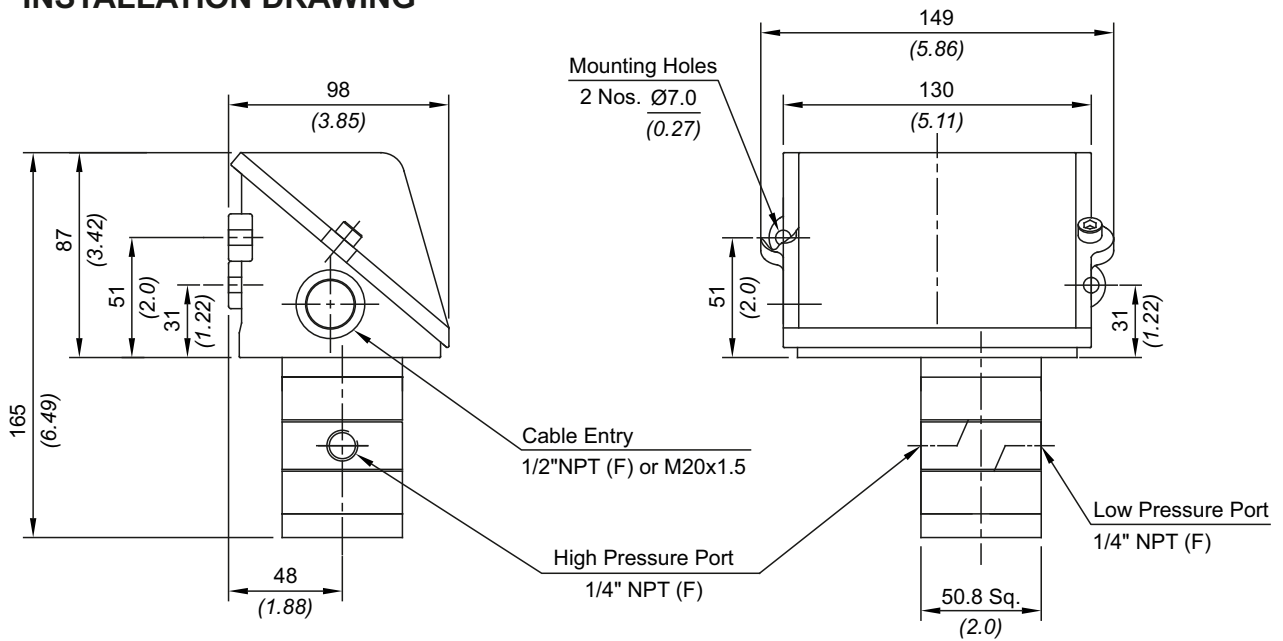

APPROX. DIMENSIONS IN  $\frac{\text{mm}}{\text{inches}}$

# MD/MT HIGH RANGE DP

## RANGE SELECTION TABLE

Range Code	Range bar (psi)	Differential* bar (psi)	Maximum Working Pressure bar (psi)
		Approximate Maximum for "A1" microswitch	
D01	0.1 - 1.0 (1.45 - 14.50)	0.12 (1.74)	70 (1015.26)
D02	0.2 - 1.5 (2.90 - 21.76)	0.20 (2.90)	70 (1015.26)
D03	0.2 - 2.6 (2.90 - 37.71)	0.20 (2.90)	70 (1015.26)
D04	0.2 - 3.6 (2.90 - 52.21)	0.40 (5.80)	70 (1015.26)
D07	0.5 - 7.0 (7.25 - 101.50)	0.80 (11.60)	70 (1015.26)
D10	0.5 - 10.0 (7.25 - 145.04)	1.00 (14.50)	70 (1015.26)
D15	1.0 - 15.0 (14.50 - 217.71)	1.50 (21.75)	70 (1015.26)
D30	5.0 - 25.0 (72.52 - 362.6)	2.00 (29.00)	70 (1015.26)

Note:

1. The minimum differential increases with the setpoint. The differential values mentioned in the above table are approximate maximum for FSR. The differential value will vary according to the pressure range selected and microswitch type. For actual values of differential please contact sales office.

2. When using 2SPDT switching arrangement, both microswitches may not actuate and/or deactuate at the same point. A small stage gap, normally upto +/- 5% FSR (depending on range code) may be observed. The On-Off differential (hysteresis) typically tends to be atleast double of those published for 1SPDT pressure switches.

If actuation and/or deactuation at same point is critical part of operation, then it can be achieved by using a separate DPDT relay. This relay will need a separate power supply for it's coil.

## HOW TO ORDER INDUSTRIAL HIGH RANGE DP SWITCHES

Group 1	Group 2	Group 3	Group 4	Group 5	Group 6	Group 7	Group 8
Non standard allocation	Model	Cable Entry Size	Switch Type	Range Code (values in bar)	Microswitch Type	Pressure Port Material / Size	Diaphragm
<input type="checkbox"/> Reserved for non-standard options not covered in catalogue. Will be given by manufacturer, only after agreement of supply details with customer.	<b>MD</b> = Industrial pressure switch with IP66 rated enclosure as per IS/IEC 60529 <b>MT</b> = Industrial pressure switch with IP66 rated enclosure as per IS/IEC 60529	<b>1</b> = Al. enclosure 1/2" NPT threads <b>*2</b> = Al. enclosure 3/4" NPT threads <b>3</b> = Al. enclosure M20 X 1.5 threads <b>7</b> = SS enclosure, 1/2" NPT threads <b>*8</b> = SS enclosure, 3/4" NPT threads <b>9</b> = SS enclosure, M20 X 1.5 threads	<b>DF1</b> = pressure difference switch, fixed differential without scale <b>DF2</b> = pressure difference switch, fixed differential with scale in bar <b>DF3</b> = pressure difference switch, fixed differential with scale in psi <b>*DA1</b> = pressure difference switch, adjustable differential without scale <b>*DA2</b> = pressure difference switch, adjustable differential with scale in bar <b>*DA3</b> = pressure difference switch, adjustable differential with scale in psi *Available with A6, A9 & B9 (in group 6) only	<b>D01</b> = (0.1 - 1.0) <b>D02</b> = (0.1 - 1.5) <b>D03</b> = (0.2 - 2.6) <b>D04</b> = (0.2 - 3.6) <b>D07</b> = (0.5 - 7.0) <b>D10</b> = (0.5 - 10.0) <b>D15</b> = (1.0 - 15.0) <b>D30</b> = (5.0 - 25.0)	<b>A1</b> = General purpose microswitch, rated at 15 A; 250 VAC <b>*A6</b> = Adjustable deadband <b>*A7</b> = 2SPDT switching elements <b>*A8</b> = General purpose microswitch <b>*A9</b> = General purpose microswitch <b>*B7</b> = 2SPDT Switching Elements <b>*B9</b> = 2SPDT Switching Elements for adjustable differential	<b>S1</b> = SS316 / 1/4" BSP(F) <b>S2</b> = SS316 / 1/4" NPT(F) <b>H1</b> = Hastelloy C / 1/4" BSP(F) <b>H2</b> = Hastelloy C / 1/4" NPT(F) <b>N1</b> = Monel / 1/4" BSP(F) <b>N2</b> = Monel / 1/4" NPT(F)	<b>0</b> = Neoprene <b>1</b> = PTFE <b>2</b> = SS 316L <b>3</b> = Hastelloy C <b>4</b> = Monel
		*Not available for MT model For dual cable entry contact Sales Office			* For detailed specifications of microswitches, please refer note under Range Selection Table	More options available. Please contact sales office.	For additional wetted parts please contact sales office

eg. A high range pressure difference industrial switch, with 1/2" NPT cable entry in aluminium housing as 1SPDT pressure switch, fixed differential without scale, having 0.1 bar to 1 bar pressure range, with 15Amp. microswitch, SS316 pressure housing with 1/4" BSP port size & neoprene diaphragm shall be specified by

Group 1	Group 2	Group 3	Group 4	Group 5	Group 6	Group 7	Group 8
<input type="checkbox"/>	MD	1	DF1	D01	A1	S1	0

Please specify full model number to avoid ambiguity.